



Nativity Card

Celebrate Christmas with this nativity scene card which features an LED for the Star of Bethlehem.

Written By: Pete Prodoehl



INTRODUCTION

Celebrate Christmas with this nativity scene card which features an LED for the Star of Bethlehem.

There's a full-color version as well as a black & white version that makes a fun coloring activity.

You can make this project (and many more!) with our **Paper Circuits Kit**.



TOOLS:

- [Scissors](#) (1)
- [Safety Pin](#) (1)

Optional

- [Push Pin](#) (1)

Optional



PARTS:

- [Paper Circuits Kit](#) (1)

Step 1 — Make Your Card

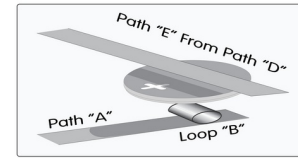
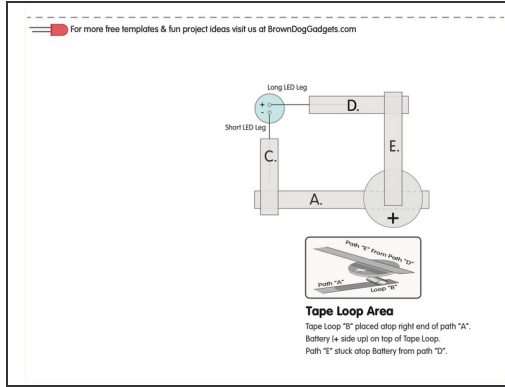

Tape Loop Area

Tape Loop "B" placed atop right end of path "A".

Battery (+ side up) on top of Tape Loop.

Path "E" stuck atop Battery from path "D".

- This paper circuits card is a great beginner project. Just follow the steps below to make your card.
 - Print out the full-color card, or print out the black and white card and color/decorate as desired.
 - Poke holes through the front of the card for the LED legs, then push the legs through the front.
 - ☑ Make note of where the **Positive** and **Negative** legs go. *Polarity matters!*
 - On the inside of the card, bend the LED legs down flat against the paper.
 - Add **Maker Tape** and a **Battery** to complete your circuit.
- ① Note: If you are using thicker paper (such as cardstock) we recommend using a large safety pin to poke the holes in the paper to put the LED legs through.